

# PLEXO<sup>3</sup> IP65 ENCLOSURES



ALL THE SPACE YOU NEED  
WITH MAXIMUM  
CONVENIENCE THROUGH  
MODULARITY



-> CATALOGUE PAGES INSIDE

THE **GLOBAL SPECIALIST**  
IN ELECTRICAL AND DIGITAL BUILDING INFRASTRUCTURES

 **legrand**<sup>®</sup>

# IDEAL FOR A MULTITUDE OF APPLICATIONS

WITH IP65 RATING PROTECTION AND OPTIMISED DIMENSIONS, PLEXO<sup>3</sup> ENCLOSURES CAN BE USED FOR DISTRIBUTION OF UP TO 72 MODULES.

The design of Plexo<sup>3</sup> enclosures makes them suitable for use in outdoor and industrial applications, as well as in agricultural and photovoltaic installations.



# STRONG WITH A HIGH IP65 RATING



High IP65 rating guaranteed for applications in damp places



Double closing point to ensure a good seal. Handle can be fitted with a lock to guarantee safety.

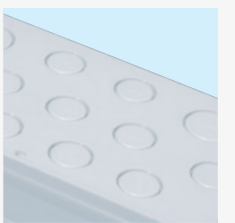

Knockout cable entries at the top, bottom and sides of the enclosure. Can also be fitted with cable glands for easier cabling



IK09 for enhanced impact resistance (shock resistant polystyrene) for longer life time



## CHARACTERISTICS

- Class II insulated enclosure
- Impact resistant reinforced polystyrene material
- IP65 - IK09
- Self-extinguishing: resistance to incandescent wire 650°C
- Conform to AS/NZS 61439.3 and IEC 62262 standards
- Colour
  - Box: light grey L750 A
  - Cover: dark grey R746 A
  - Marker holder: transparent blue
- Rated operating and insulation voltage of 400V a.c. 50/60 Hz
- 10 sizes of enclosures
  - 4 to 72 modules
  - 12 modules with 1 to 3 rows
  - 18 modules with 1 to 4 rows

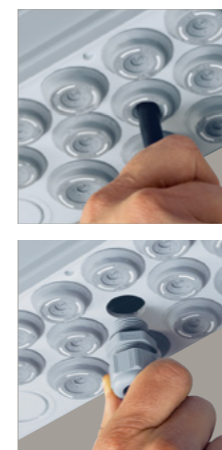

## CLEVER ACCESSORIES THAT SAVE YOU TIME

- Different sizes of direct piercing end caps can be mounted at the top, bottom and sides of the enclosure
- Cable glands can be fitted according to your requirements

## DIRECT PIERCING END CAPS

- ISO membrane glands can be pierced directly by the cable
- Tool free fitting and removal
- IP65 guaranteed with the cable inserted.
- Larger cable capacity than a standard cable gland
- Cable held securely in the membrane gland



# SPEED AND EASE OF INSTALLATION

Removable faceplate for easier maintenance of individual rows

Enclosures fitted with terminal blocks, which can easily be repositioned, at the top and bottom of the box

Rails can be removed one by one

Removable chassis for wiring outside the enclosure

# MAXIMUM CONVENIENCE THROUGH MODULARITY

Space behind the rails  
- 2 position rails with adjustable depth  
45 mm

Space between the rails  
- allowing cables to run easily  
150 mm

Space at the side of the DIN rail to run cable through easily  
38 mm

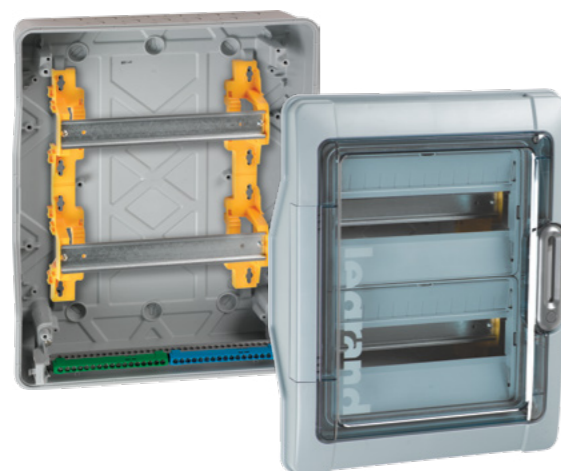

## DOOR AND ENCLOSURE ARE BOTH FULLY REVERSIBLE

It makes no difference whether the wiring runs from the top or the bottom.



## MATERIALS

- Box, cover, rail brackets, terminal brackets, hinge cover and faceplate: impact reinforced polystyrene
- Door: transparent polycarbonate
- Handle and door identifier indicator light: polycarbonate
- Handle bar: glass fibre-reinforced polycarbonate
- Entry glands: polypropylene + SEBS
- Cover/box screws and springs: stainless steel
- Other screws: zinc-coated steel
- Rails: galvanised steel

# PLEXO<sup>3</sup>

## ACCESSORIES FOR CABINET

### JOINING KITS

The joining kit is used to join 2 enclosures of the same or different heights horizontally, or 2 enclosures of the same width vertically, or to join a vertical or horizontal multi-function sleeve to a Plexo<sup>3</sup> cabinet.

JOINING KIT  
Cat. No. 0 016 67

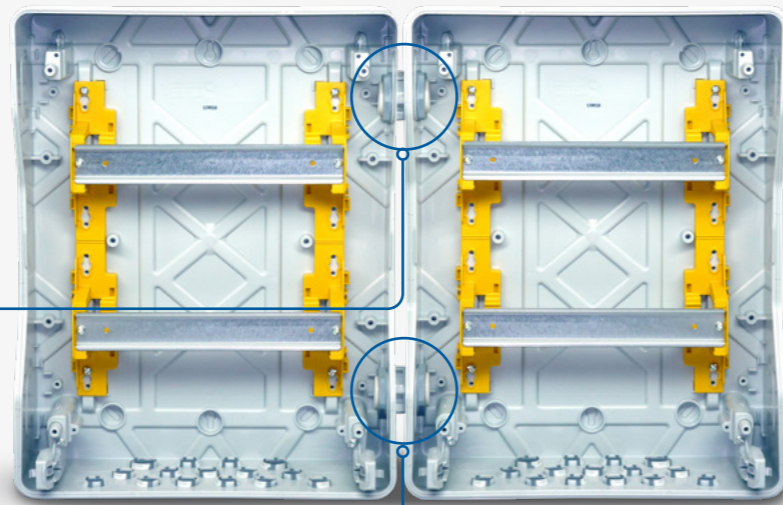

Joined enclosures or sleeves must be fixed to the wall. The kit comprises of 2 identical accessories which provide a 26mm diameter feedthrough for cables, while maintaining overall IP65 protection.



There are 32 mm diameter cut-outs on the vertical and horizontal sides of the enclosures, which allow for joining accessories to be fitted.

### FIXING ACCESSORIES FOR TERMINAL BLOCKS

A single or double support for terminal blocks can be added at the top or bottom of the enclosures

These accessories take empty supports for terminal blocks cat. no 0 048 17 (12-module enclosures) and cat. no 4 048 21 (18-module enclosures) on which empty screw terminal blocks cat. nos 0 048 01 to 07 can be installed.

SINGLE SUPPORT  
FOR 1 OR 2 ROW ENCLOSURES  
Cat. No. 0 019 72

DOUBLE SUPPORT  
FOR 3 OR 4 ROW ENCLOSURES  
Cat. No. 0 019 73

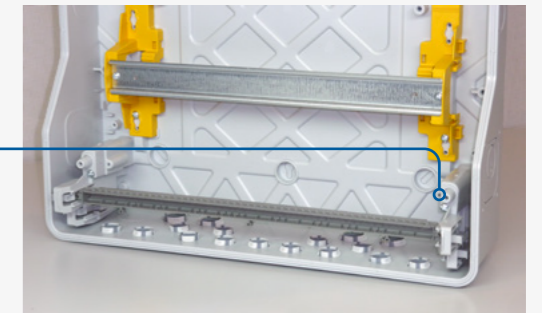

### HEAT REFLECTIVE PANEL

While maintaining an IP65 rating, the new heat reflective panel helps to further reduce heat inside the enclosure. Available for all 12 and 18 modules enclosures.

- Light grey
- 2mm opal acrylic
- Fast and secure installation (less than 1 min)
- All in 1 kit (panel + mounting accessories included)



# Plexo<sup>3</sup>

## Enclosures



Self-extinguishing: resistance to incandescent wire 650°C AS/NZS 61439.3  
 IP65 - IK09  
 Class II insulated enclosure  
 Door and enclosure fully reversible  
 Removable chassis and faceplates from 2-row versions up to 2 position rail for modular products and moulded cases  
 Spacing between rails 150 mm

Lockable door handle, sealable cover and faceplate  
 Shock-resistant polystyrene material  
 Box colour light grey L750A, cover colour dark grey R746A  
 Supplied with IP2X Earth and Neutral terminal blocks  
 Spare blanking plate included as a standard from 12 modules  
 Blanking Inserts available for direct sunlight installation.  
 Available on request.

Pack	Cat.Nos	Enclosures 4 to 8 module	
		Number of rows	Number of modules
1	6 019 74	1	4
1	6 019 76	1	6
1	6 019 78	1	8

  

Pack	Cat.Nos	Enclosures 12 modules per row	
		Number of rows	Number of modules
1	6 019 81	1	12
1	6 019 82	2	24
1	6 019 83	3	36

Pack	Cat.Nos	Enclosures 18 modules per row	
		Number of rows	Number of modules
1	6 019 85	1	18
1	6 019 86	2	36
1	6 019 87	3	54
1	6 019 88	4	72

Pack	Cat.Nos	Accessories	
1	0 019 66	<b>Key lock</b> N° 850	
1	0 019 69	<b>Fixing lugs</b> Set of 4 wall mounting lugs	
1	0 019 61	<b>Blanking plates</b> 5, separable into modules or 1/2 module, Grey R746A	
1	0 019 55	<b>Direct piercing end caps</b> Pack consisting of 2 Ø32mm ISO end caps, 5 Ø25mm ISO end caps and 10 Ø20mm ISO end caps	
2	0 019 67	<b>Joining kit</b> Allows cables to be run horizontally or vertically between 2 enclosures or multifunction sleeves while maintaining IP65 protection	
1	0 019 62	<b>Perforated plates</b> Allow the DIN rail to be replaced with a Lina 25 plate when integrating non-modular products For 18 modules enclosures Height 150mm	
	6 019 81-HRP 6 019 82-HRP 6 019 83-HRP 6 019 85-HRP 6 019 86-HRP 6 019 87-HRP	<b>Heat Reflective Panel</b> Reduces heat in the enclosure For direct sunlight applications Light grey colour	
1	0 019 72	<b>Mounting supports for terminal blocks</b> Fixing accessories for terminal blocks	
1	0 019 73	Single support for 1 or 2 row enclosures Double support for 3 or 4 row enclosures	

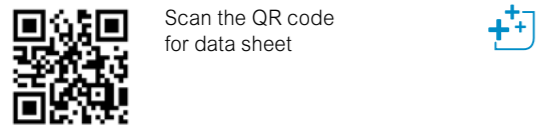

# Plexo<sup>3</sup>

## Distribution terminal blocks

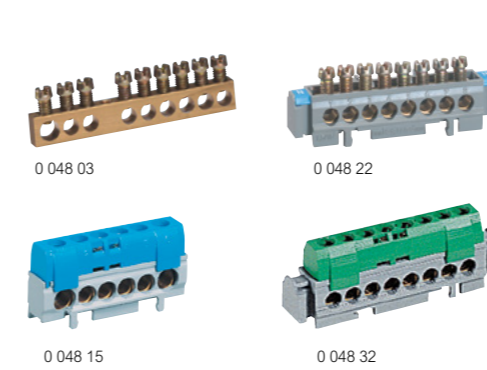

Pack	Cat.Nos	Distribution terminal blocks	
		Conform to standard IEC 60998-2-1 Supplied ready for use (screws not tightened) 100 A max. - 400 V~ with 25 mm <sup>2</sup> input 80 A max. - 400 V~ with 16 mm <sup>2</sup> input	
		<b>Screw terminal blocks</b> Fit with Ø M4 screws	
		Number of connections (mm <sup>2</sup> )	Length (mm)
10	0 048 01	1 x 6 to 25 + 4 x 1.5 to 16	45
10	0 048 03	1 x 6 to 25 + 8 x 1.5 to 16	73
10	0 048 05	1 x 6 to 25 + 14 x 1.5 to 16	122
10	0 048 06	1 x 6 to 25 + 19 x 1.5 to 16	157
10	0 048 07	1 x 6 to 25 + 25 x 1.5 to 16	192
		<b>Terminal blocks on support</b> Mounting on U or L rail with universal support Cat.No 0 048 11, or on 12 x 2 flat bar Supplied with Duplix markers	
10	0 048 20 <sup>1</sup>	4 x 1.5 to 16	47
10	0 048 22 <sup>1</sup>	8 x 1.5 to 16	75
10	0 048 24 <sup>1</sup>	1 x 6 to 25 + 12 x 1.5 to 16	113
10	0 048 25 <sup>1</sup>	1 x 6 to 25 + 16 x 1.5 to 16	141
10	0 048 26 <sup>1</sup>	1 x 6 to 25 + 21 x 1.5 to 16	176
10	0 048 28 <sup>1</sup>	1 x 6 to 25 + 33 x 1.5 to 16	276
		<b>IP 2X terminal blocks</b> Mounting on U or L rail with universal support Cat.No 0 048 11, or on 12 x 2 flat bar	
10	0 048 16 0 048 15	1 x 10 to 35 + 5 x 6 to 25	62
10	0 048 50 0 048 40	4 x 1.5 to 16	47
10	0 048 52 0 048 42	8 x 1.5 to 16	75
10	0 048 54 0 048 44	1 x 6 to 25 + 12 x 1.5 to 16	113
10	0 048 45	1 x 6 to 25 + 16 x 1.5 to 16	141
10	0 048 46	1 x 6 to 25 + 21 x 1.5 to 16	176
10	0 048 48	2 x 6 to 25 + 33 x 1.5 to 16	276
		<b>Earth (green)</b>	
10	0 048 30	4 x 1.5 to 16	47
10	0 048 32	8 x 1.5 to 16	75
10	0 048 34	1 x 6 to 25 + 12 x 1.5 to 16	113
10	0 048 35	1 x 6 to 25 + 16 x 1.5 to 16	141
10	0 048 36	1 x 6 to 25 + 21 x 1.5 to 16	176
10	0 048 38	2 x 6 to 25 + 33 x 1.5 to 16	276
		<b>Supports for terminal blocks</b>	
1	0 048 10	Requires fixing accessory 0 019 72/73 Distribution block support for connecting up to 4 IP 2X terminal block of the same size to create a distribution block	
5	0 048 11	Universal support for mounting an terminal blocks on U or L rail 35-holes empty support, for screw terminal blocks Length: 276 mm	
5	0 048 17	Empty supports with 50 holes - for 18 modules Plexo <sup>3</sup> range Length - 385 mm	

<sup>1</sup>: Each terminal block is supplied with:  
 - 2 green Duplix marked +  
 - 2 blue Duplix marked N  
 - 2 red Duplix marked L

# Plexo<sup>3</sup>

## Supply busbars and distribution terminal blocks

### Selection of protections for supply busbars

Supply busbars Cat.Nos	Protections Cat.Nos
4 049 26/28/33/37	4 049 89
4 049 10/34/42/43	4 049 90
4 049 15/16/19/20/40/41/44/45/66/67	4 049 91
4 049 09/11/12	4 049 93
4 049 13/14/38/39	4 049 94
4 049 17/18/87	4 049 95

### Mounting of terminal blocks on support

#### On 12 x 2 flat bar



#### On support for terminal blocks Cat.No 0 048 17

Enables you to make exactly the right number of connections

#### Example:

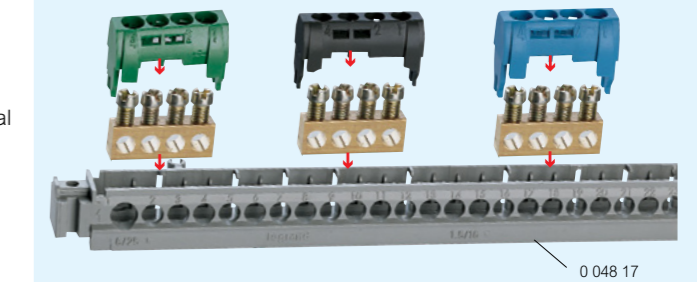

#### Universal support Cat.No 0 048 11

Mounted on U or L rail, takes all terminal blocks

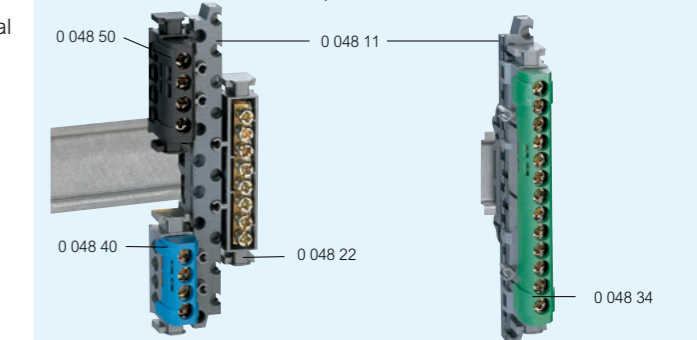

#### On distribution block support Cat.No 0 048 10

Possibility of forming a 2P, 3P or 4P distribution block by associating IP 2X terminal blocks

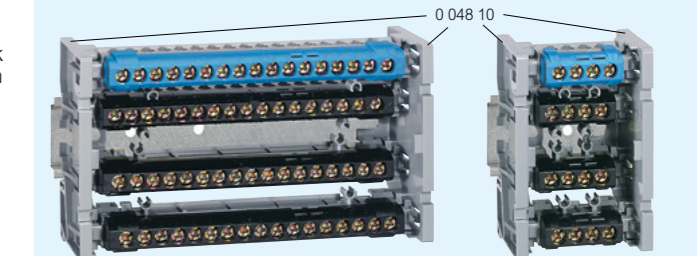

# PLEXO<sup>3</sup> DIMENSIONS

## ■ Dimensions

### Enclosures 4, 6 and 8 modules

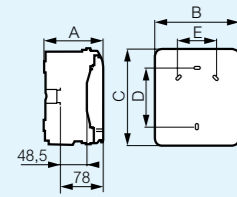

Cat.Nos	Dimensions (mm)				
	A	B	C	D	E
601974	115.6	128	200	120	-
601976	115.6	164	200	120	70
601978	115.6	200	200	120	106

### Enclosures 12, 24 and 36 modules

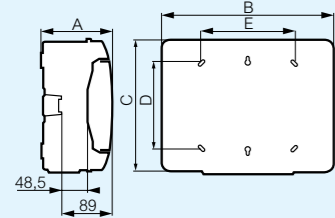

Cat.Nos	Dimensions (mm)				
	A	B	C	D	E
601981	141	340	282	180	180
601982	161	340	432	330	180
601983	161	340	622	480	180
601985	141	448	282	180	290
601986	161	448	432	330	290
601987	161	448	622	480	290
601988	161	448	822	680	290

## ■ Recommended installation positioning

To reach best performance and longevity, it is recommended that enclosures are sheltered from direct sunlight and rain in horizontal / inclined positioning

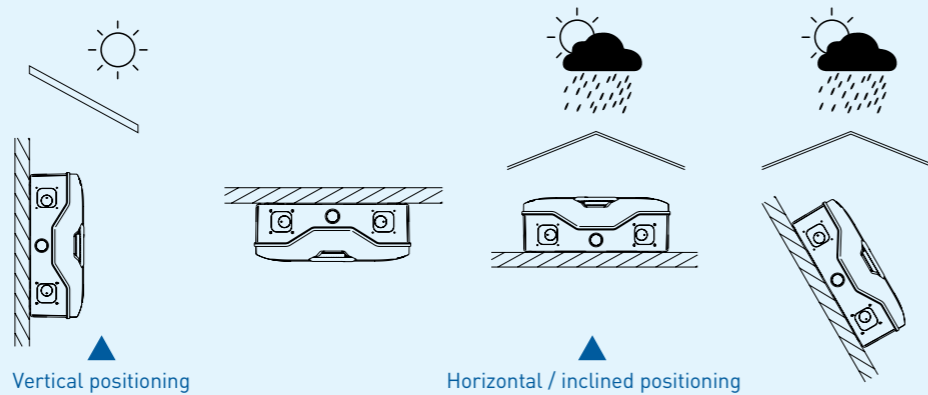

Vertical positioning

Horizontal / inclined positioning

## ■ Storage and installation temperature

601974/76/78 enclosure: -15°C to 55°C (+70°C/24H)

601981/82/83/85/86/87/88 enclosure: -25°C to 55°C (+70°C/24H)

Operating temperature: -25°C to 40°C

## ■ Number of knockouts on each side

Cat.Nos	Top / bottom			Left / right		
	Ø20mm	Ø25mm	Ø32mm	Ø20mm	Ø25mm	Ø32mm
601974	2	1	-	2	-	-
601976	4	1	-	2	-	-
601978	6	1	-	2	-	-
601981	7	2	2	-	-	2
601982	13	2	2	-	-	3
601983	13	2	2	-	-	4
601985	12	2	3	-	-	2
601986	13	4	3	-	-	3
601987	13	4	3	-	-	1
601988	13	4	3	-	-	5

## ■ Direct piercing end caps

Cat.No	Type	Number of end caps per pack	Ø	
			Min. (mm)	Max. (mm)
001955	ISO20	10	4	13
	ISO25	5	9	18
	ISO32	2	12	25

## ■ Earth and neutral terminal blocks

Cat.No	Earth bar	Neutral bar
601974	4 x 16mm <sup>2</sup>	4 x 16mm <sup>2</sup>
601976	4 x 16mm <sup>2</sup>	4 x 16mm <sup>2</sup>
601978	8 x 16mm <sup>2</sup>	8 x 16mm <sup>2</sup>
601981	13 x 25mm <sup>2</sup>	13 x 25mm <sup>2</sup>
601982	1 x 25mm <sup>2</sup> + 16 x 16mm <sup>2</sup>	1 x 25mm <sup>2</sup> + 16 x 16mm <sup>2</sup>
601983	1 x 25mm <sup>2</sup> + 21 x 16mm <sup>2</sup>	1 x 25mm <sup>2</sup> + 21 x 21mm <sup>2</sup>
601985	1 x 25mm <sup>2</sup> + 16 x 16mm <sup>2</sup>	1 x 25mm <sup>2</sup> + 16 x 16mm <sup>2</sup>
601986	1 x 25mm <sup>2</sup> + 21 x 16mm <sup>2</sup>	1 x 25mm <sup>2</sup> + 21 x 16mm <sup>2</sup>
601987	1 x 25mm <sup>2</sup> + 26 x 16mm <sup>2</sup>	1 x 25mm <sup>2</sup> + 26 x 16mm <sup>2</sup>
601988	1 x 25mm <sup>2</sup> + 34 x 16mm <sup>2</sup>	1 x 25mm <sup>2</sup> + 34 x 16mm <sup>2</sup>

## Notes



TO DOWNLOAD  
THE CATALOGUE  
[SCAN THE QR CODE](#)



**Legrand Australia**  
Building 4, Nexus Industry Park  
43-47 Lyn Parade, Prestons NSW 2170  
Tel.: 1300 369 777  
[www.legrand.com.au](http://www.legrand.com.au)

**Legrand New Zealand**  
106-124 Target Road  
Glenfield, Auckland 0627  
Tel.: 0800 476 009  
[www.legrand.co.nz](http://www.legrand.co.nz)